

THIS COPY IS PROVIDED ON A RESTRICTED BASIS AND IS NOT TO BE USED IN ANY WAY DETRIMENTAL TO THE INTERESTS OF PANDUIT CORP.

COVER

BASE

PANDUIT P/N	WEIGHT
T702EE	1.211 LBS [549.31 g]

△E
△A

- NOTES:
- SEE CURRENT CATALOG FOR ADDITIONAL PART SUFFIXES TO INDICATE COLOR AND PACKAGE QUANTITY.
 - THIS PART IS INTENDED TO BE USED WITH PANDUIT TWIN 70 RACEWAY.
 - DIMENSIONS IN PARENTHESES ARE IN METRIC.

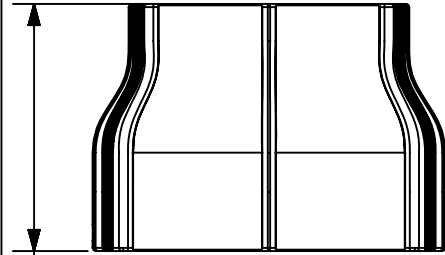

6.66 △G
[169.1]

CONCENTRIC BREAKOUTS FOR CONDUIT SIZES: 1/2", 3/4", 1", 1 1/4", 1 1/2"

3.28 △G
[83.3]

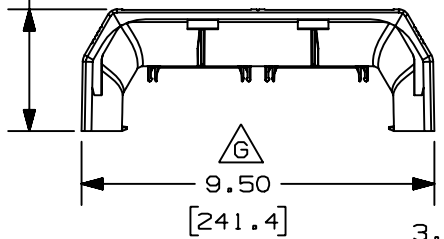

9.50 △G
[241.4]

3.16
[80.4]

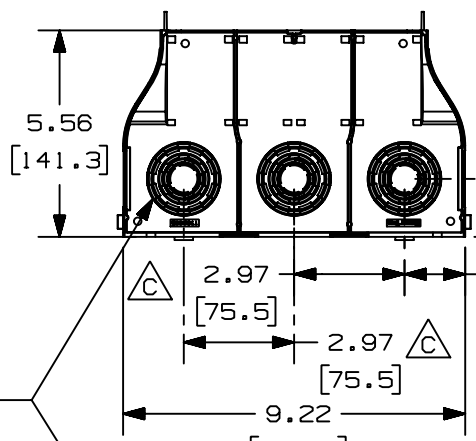

5.56
[141.3]

△C
1.56
[39.7]

△C

2.97
[75.5]

2.97 △C
[75.5]

9.22
[234.1]

△C
1.63
[41.5]

INSERT △D

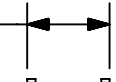

1.73
[43.9]

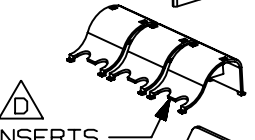
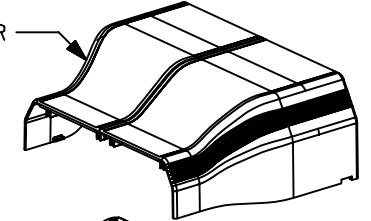

3 INSERTS △D

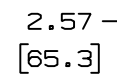

2.57
[65.3]

BASE

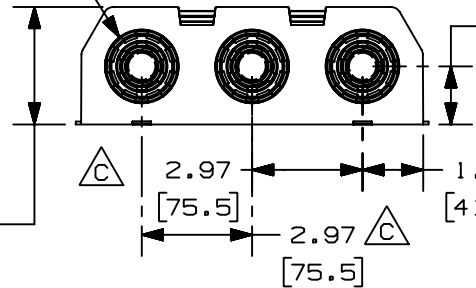

△C
1.56
[39.7]

△C

2.97
[75.5]

2.97 △C
[75.5]

1.63 △C
[41.5]

CAD FILENAME/LAYERS △F D34866DX_DC_T702EE_03A.PRT

PANDUIT CORP. TINLEY PARK, ILLINOIS

T702 ENTRANCE END FITTING (T702EE) CUSTOMER DRAWING

UNLESS OTHERWISE SPECIFIED, DIMENSIONAL TOLERANCES ARE: (.X) ± (.XXX) ± (.XX) ±.03 (.8) ANGLES ±		UNLESS OTHERWISE SPECIFIED, ALL DIMENSIONS ARE GIVEN IN INCHES, THIRD ANGLE PROJECTION.	
DRAWN BY DW	MAT'L: PVC	SCALE NONE	DWG A
DATE 02-27-98	△A	DRAWING NO. 34866-71	SIZE A
CHECKED BY HIW			

REV	DATE	BY	CHK	DESCRIPTION	ECN	CHK	CUST	SUP
-	-----	---	--	H. REVISED PART DESCRIPTION: T702 ENTRANCE END FITTING WAS TWIN 70 ENTRANCE END	-----	-----	-----	
-	-----	---	--	G. ADDED DIMENSIONS F. REVISED CAD FILE NAME	-----	-----	-----	
3	08-13-04	JBN	PM	E. REVISED WEIGHT INFORMATION D. ADDED BEND RADIUS INSERTS	34866-71	RGRO	RGRO	
2	03-15-00	JHNU	BKR	C. ADDED DIMENSIONS FOR BREAKOUTS	34866-71	HIW	HIW	
1	07-27-99	DW	HIW	B. REVISED TITLE NAME A. MAT'L WAS ABS/PC AND REVISED WEIGHT	34866-71	HIW	HIW	
R	02-27-98	DW	HIW	RELEASED TO PRODUCTION	34866-71	HIW	HIW	